

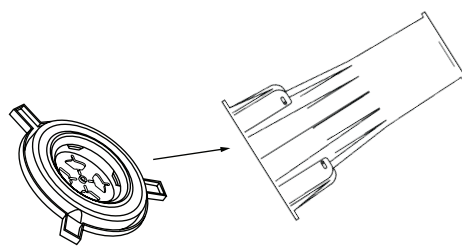

**! IMPORTANT** The intumescent sleeve must not be altered or tampered with.

<p>1</p>	<p>Verify that the intended use of the collar is supported by a compliant report. See <a href="http://snapcollars.com.au">snapcollars.com.au</a> for compliant solutions.</p> <p>Inspect the collar to make sure it has not been damaged in transit and all components are present.</p> <p>Insert the locator plate (4) into the base of the collar. Look down through the top of the collar and use the alignment window (4b) of the locator plate (4) to position the collar on the formwork.</p>	
<p>2</p>	<p>Secure the collar to the formwork fixing through the base flange (3), ensuring it is flat on the formwork and no concrete slurry will get in.</p>	
<p>3</p>	<p>Fit the cap (8) to the top of the collar or extension. The collar is now ready for the concrete to be poured.</p> <p>Note: If the slab thickness exceeds 250mm, collar extensions will be required.</p>	<div style="display: flex; justify-content: space-around;"> <div style="text-align: center;"> <p>Without extension</p>  </div> <div style="text-align: center;"> <p>With extension</p>  </div> </div>
<p>4</p>	<p>After the slab has cured, remove the formwork and the locator plate.</p> <p>Inspect the collar to ensure that no residual concrete remains in the active area of the collar including the spring pockets, (5) around the fuselinks and springs.</p>	
<p>5</p>	<p>If sealant is required around the annulus between the pipe and the slab, cut the collar down flush with the slab.</p>	

Turn page for final step.

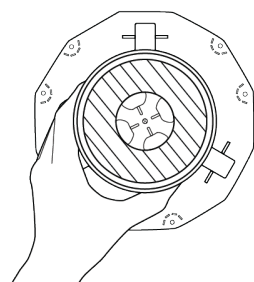
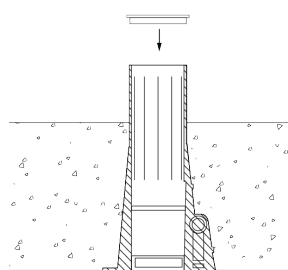
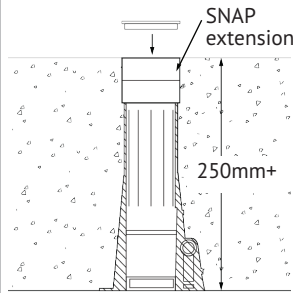
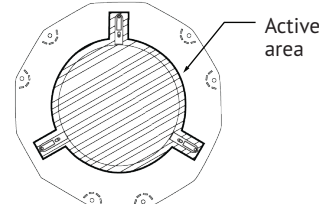
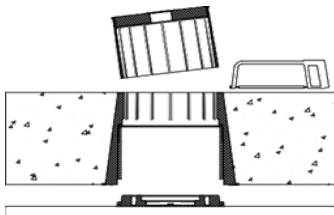

**⚠ IMPORTANT** The intumescent sleeve must not be altered or tampered with.

Install the required pipe by sliding it through the collar taking care not to damage the internal collar components. Then;

**(i)** For stack installations, seal between the pipe and edge of penetration (See [FCO3426](#) for sealant details)

**(ii)** For floor waste installations, apply a grout screed up to the pipe to the required minimum depth. (See [FCO3426](#) for depth requirements.)

**(i)** Stackwork Pipes

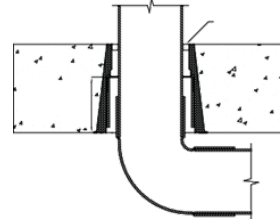

**(ii)** Floorwaste and Shower Systems

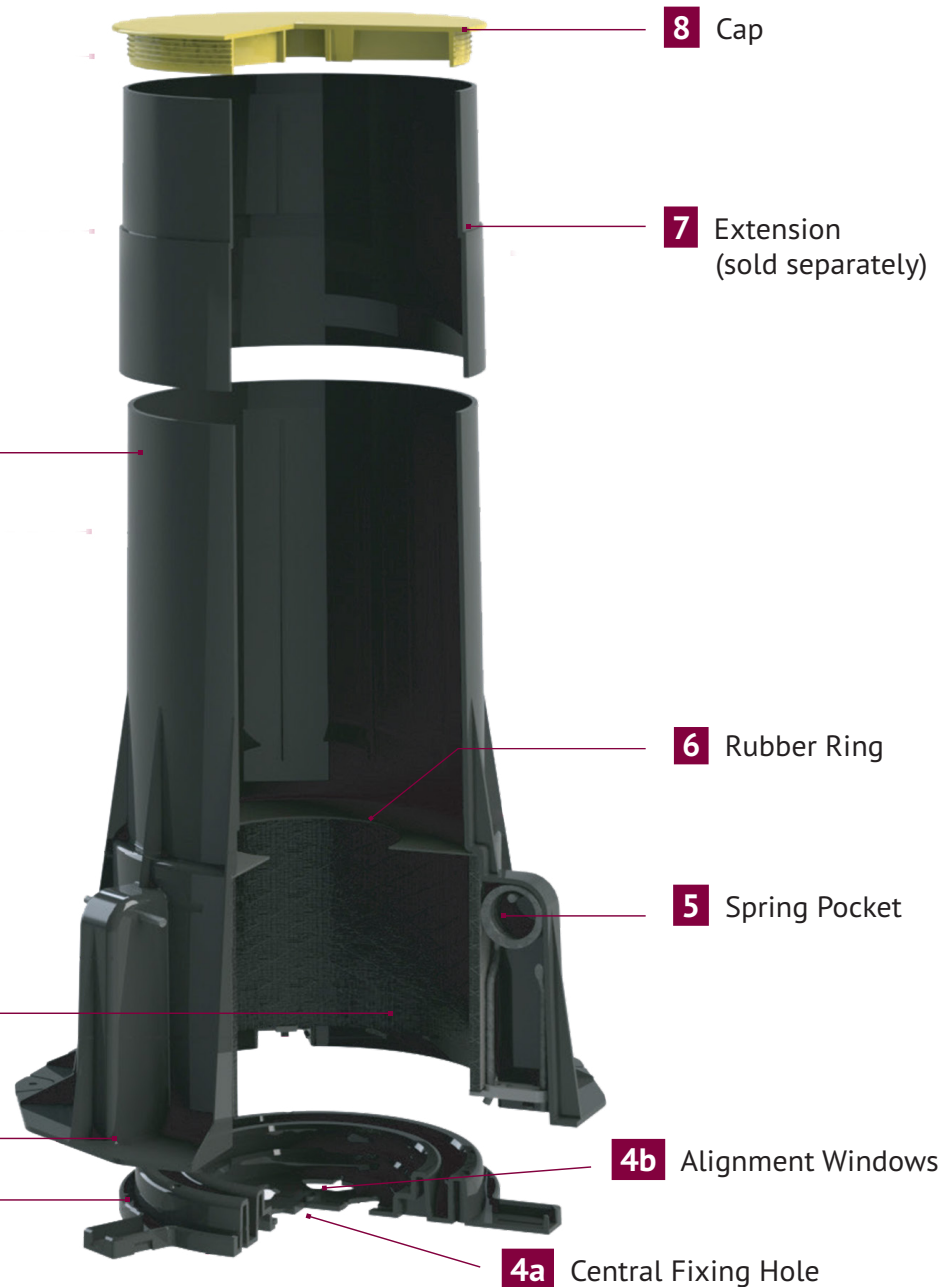
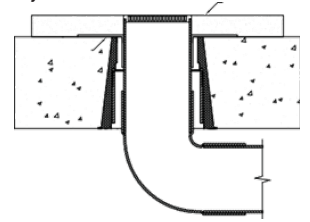

H100FWS pictured

Page 2 of 2